

# Schlossaustausch 179 NW



## 179 NW-08

	<i>HAZET</i> No.	
①	179 NW-08 Schloss	1



## Schloss-Ausbau

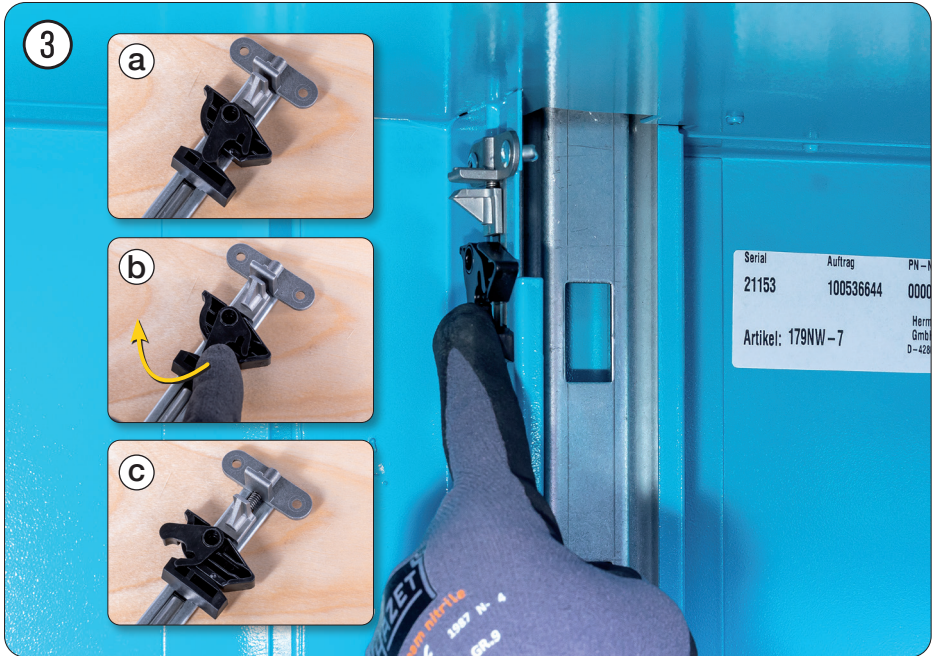
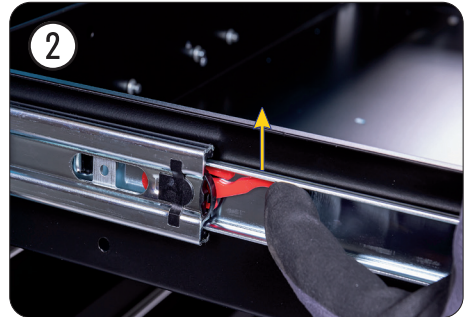

Innensechskantschlüssel 6 mm ● (Bilder a bis d)

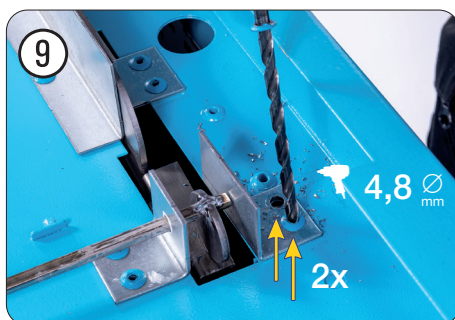
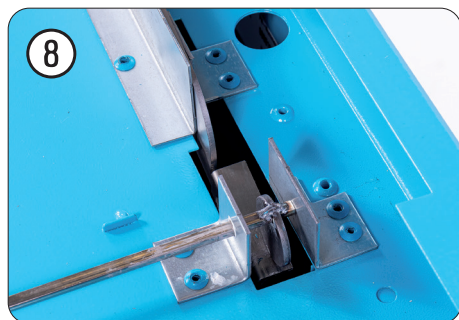
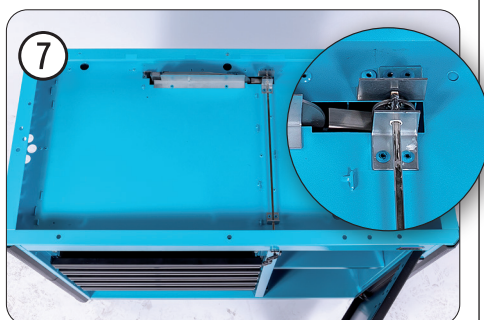
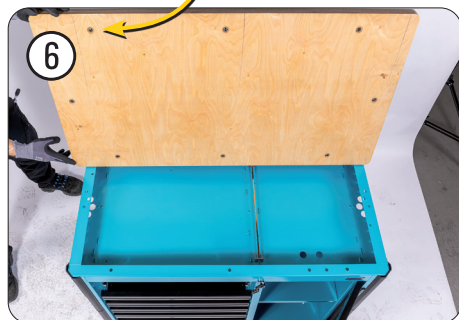
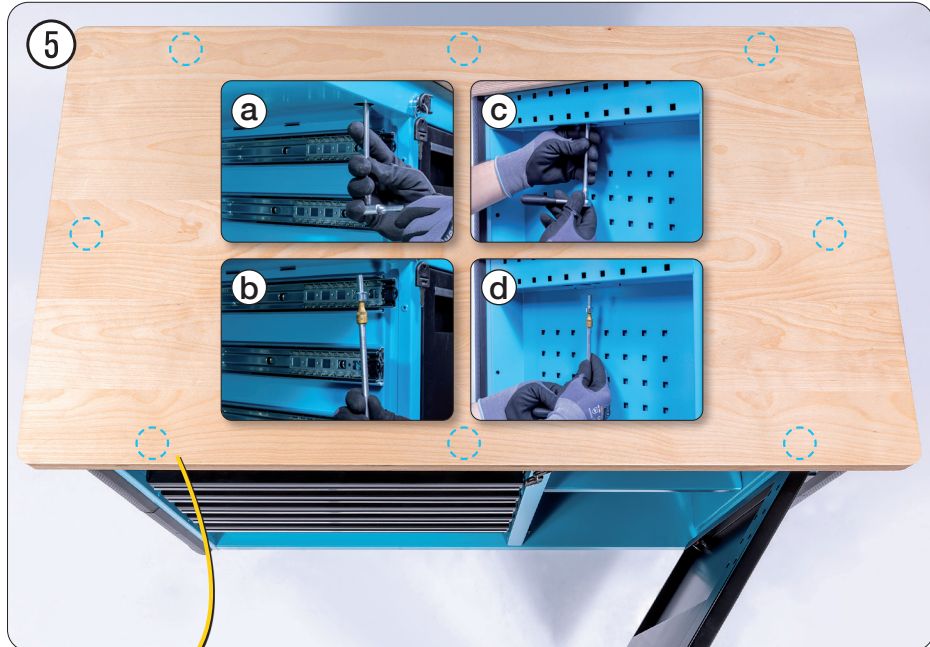



# Schloss-Ausbau

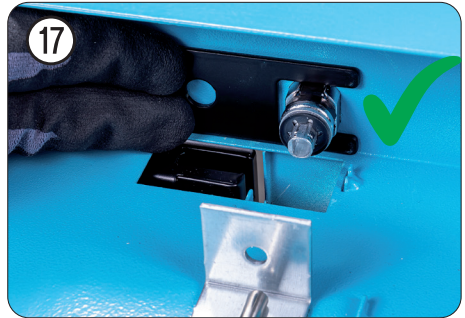
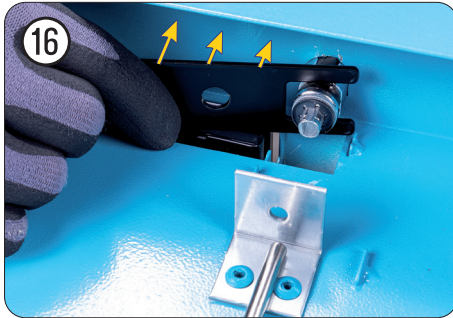
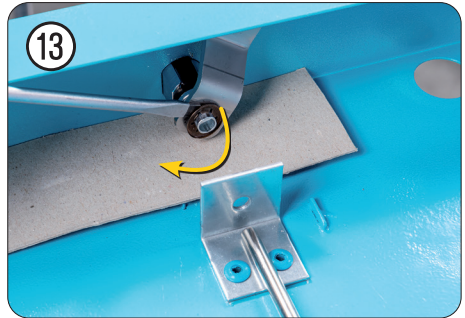
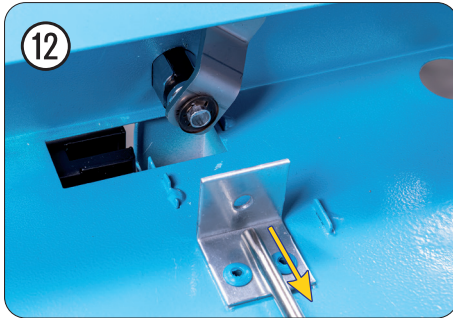
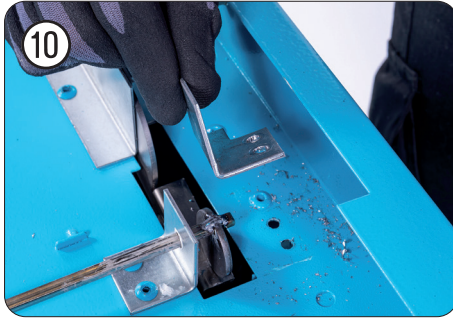





# Schloss-Einbau

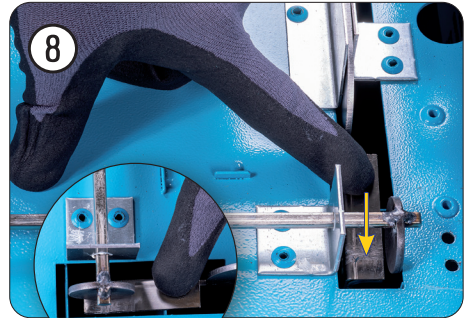
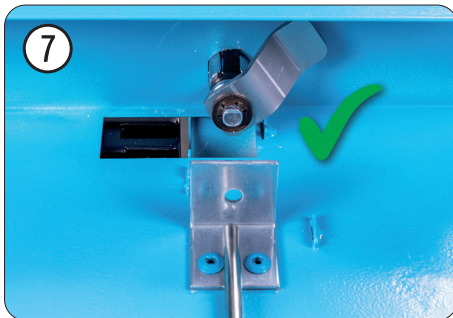
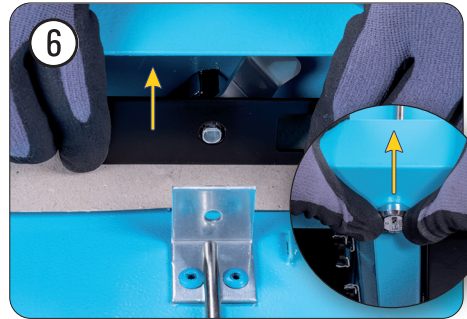
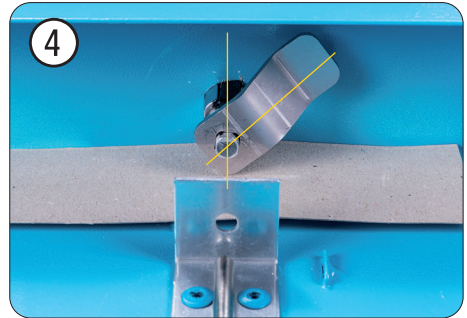
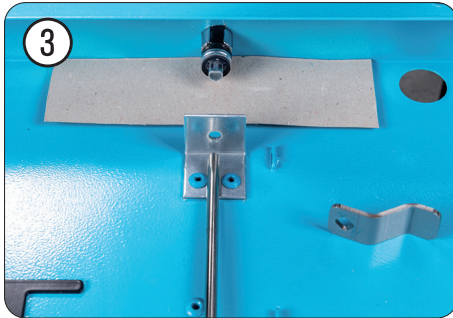
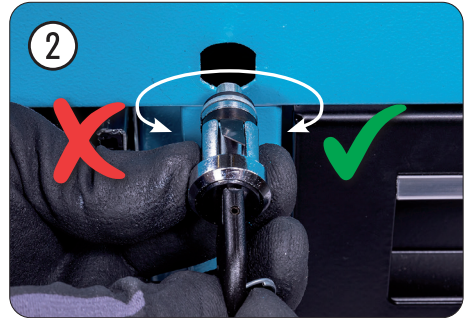
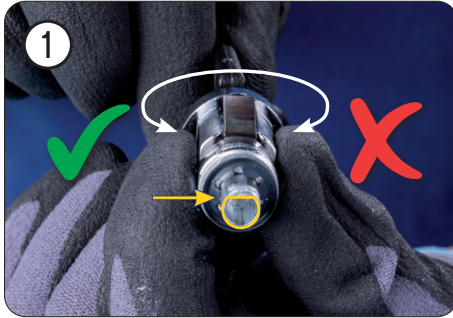

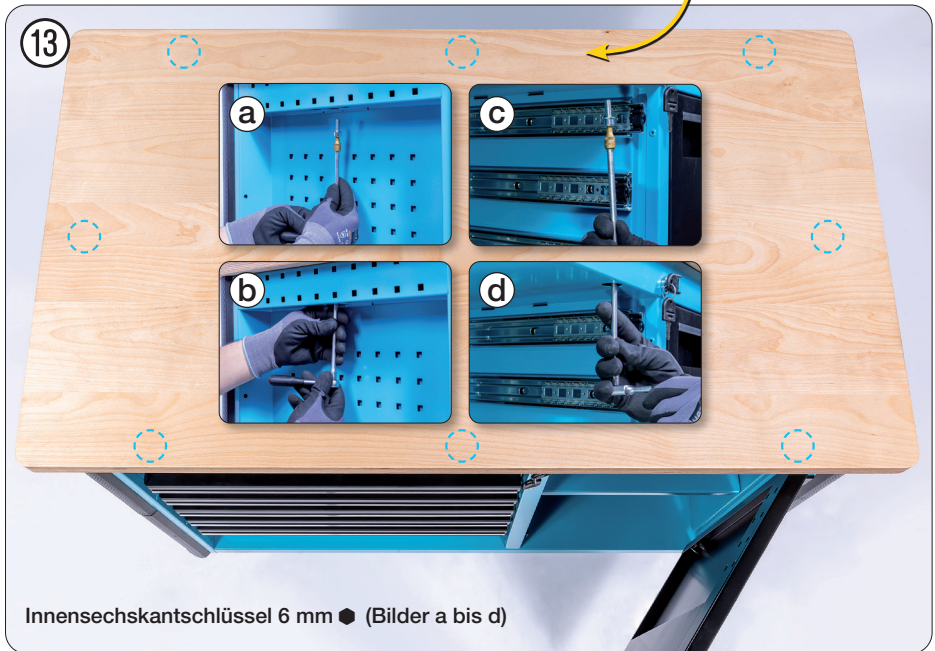
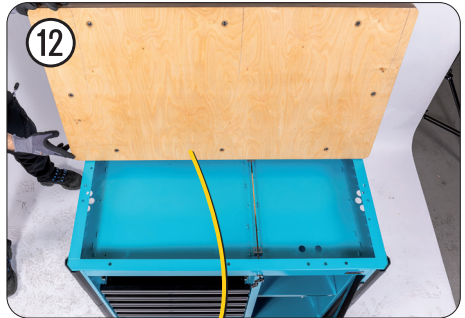
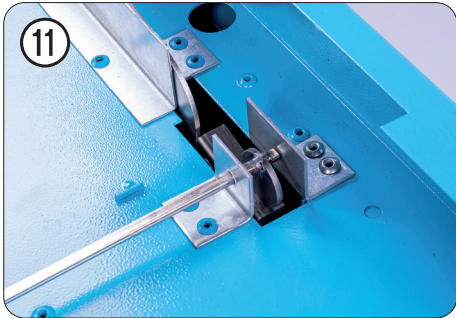
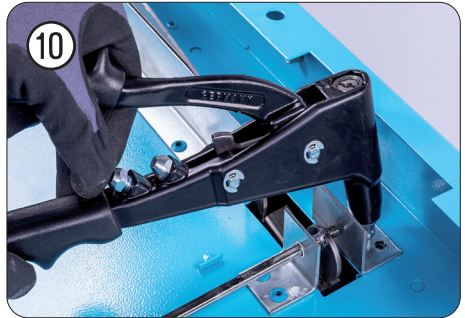
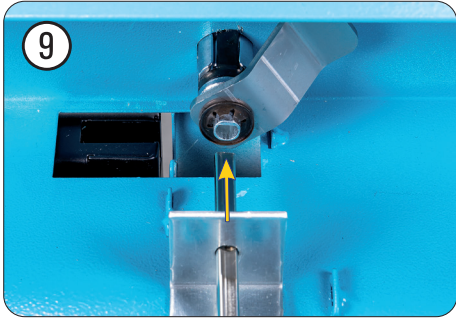

Innensechskantschlüssel 6 mm ● (Bilder a bis d)





Falls der Schlüssel fehlt oder im Schloss abgebrochen ist, das Schloss 15 mm tief aufbohren. Dann vorsichtig weiter bohren, bis der Schlitz zum manuellen Öffnen sichtbar ist.

**TIPP**

## Notizen

---



---



---



---



---



---



---



---

**HAZET-WERK** Hermann Zerver GmbH & Co. KG

🏠 Güldenwerther Bahnhofstraße 25 - 29 · 42857 Remscheid · GERMANY

✉ 10 04 61 · 42804 Remscheid · GERMANY

☎ +49 (0) 21 91/7 92-0 · 📠 +49 (0) 21 91/7 92-375 · 🌐 hazet.de · 📧 info@hazet.de